

PROPOSED RETAIL DEVELOPMENT FOR: MR. GLEN CHAPMAN
WOODBURY HWY & CAMPBELL LANE **MANCHESTER, TENNESSEE**

SOIL EROSION AND SEDIMENT CONTROL LEGEND		
(CE)	CONSTRUCTION EXIT	
(SF)	SEDIMENT BARRIER	
(RR)	RIP-RAP	
DISTURBED ACREAGE = 0.6± ACRES		

CHAPMAN LOYD GLENN
P O BOX 1835
MANCHESTER TN 37349

MAP = 076A
GROUP = C
PARCELS = 003.00
& 004.00

WDB. 441, pg. 28,
ROCCTn.

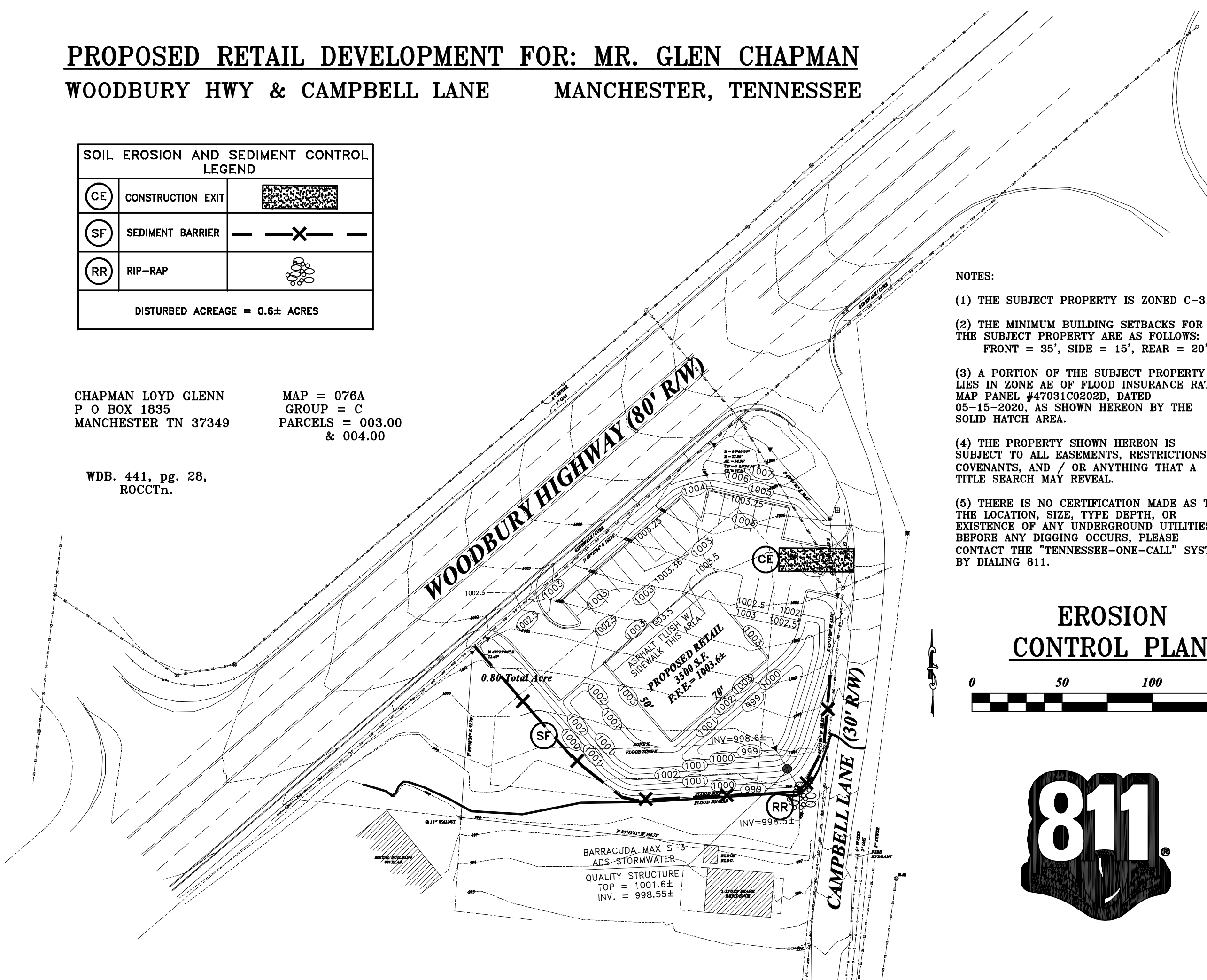

NOTES:

- (1) THE SUBJECT PROPERTY IS ZONED C-3.
- (2) THE MINIMUM BUILDING SETBACKS FOR THE SUBJECT PROPERTY ARE AS FOLLOWS:
FRONT = 35', SIDE = 15', REAR = 20'
- (3) A PORTION OF THE SUBJECT PROPERTY LIES IN ZONE AE OF FLOOD INSURANCE RATE MAP PANEL #47031C0202D, DATED 05-15-2020, AS SHOWN HEREON BY THE SOLID HATCH AREA.
- (4) THE PROPERTY SHOWN HEREON IS SUBJECT TO ALL EASEMENTS, RESTRICTIONS, COVENANTS, AND / OR ANYTHING THAT A TITLE SEARCH MAY REVEAL.
- (5) THERE IS NO CERTIFICATION MADE AS TO THE LOCATION, SIZE, TYPE DEPTH, OR EXISTENCE OF ANY UNDERGROUND UTILITIES. BEFORE ANY DIGGING OCCURS, PLEASE CONTACT THE "TENNESSEE-ONE-CALL" SYSTEM BY DIALING 811.

EROSION CONTROL PLAN



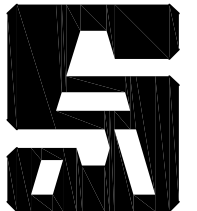

SADLER & ASSOCIATES CONSULTING ENGINEERS INCORPORATED

CIVIL • ENVIRONMENTAL
TRAFFIC • PLANNING
CONSTRUCTION MANAGEMENT

Phone: 931-728-4961

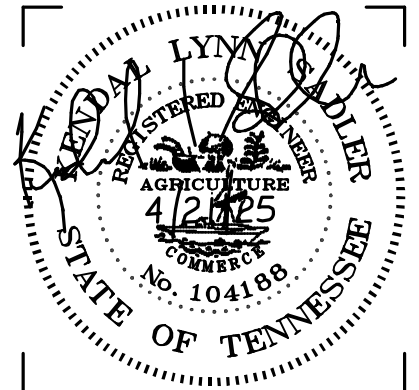

DRAWING NO.

C-4

DATE: 4/21/25